

Oasis 4-Piece, 60 x 32 Bathtub With ActivLife 2-Bar (2-horizontal) Package



Specification – Oasis 4-piece, 60 x 32-inch deep, FRP gelcoat bathtub model TS4P-6032, offered in a standard 16-inch or 17.25-inch (ABF) apron height. ActivLife package includes a horizontal bar on the back wall and the control wall.

Standards Certification:

The bathtub listed is manufactured in compliance with ANSI Z124 Standards, and certified through an ongoing, independent quality assurance and testing program.

The factory-applied grab bar package is certified through an independent review program.

32-inch / Private Access / Bars Only

Oasis

TS4P-6032 R / BP1-60
(RH drain / 2-bar package)
Model & Package Illustrated

	Base Unit	ABF Unit
A	77"	78-1/4"
B	75-3/4"	77"
C	16"	17-1/4"
D	1-3/4"	3"
E	13-3/4"	15"
F	22-3/4"	24"

NOTE: Positioning of factory attached grab bars allow for the installation of a shower enclosure.



Home Innovation
LAB CERTIFIED™

ActivLife
solutions

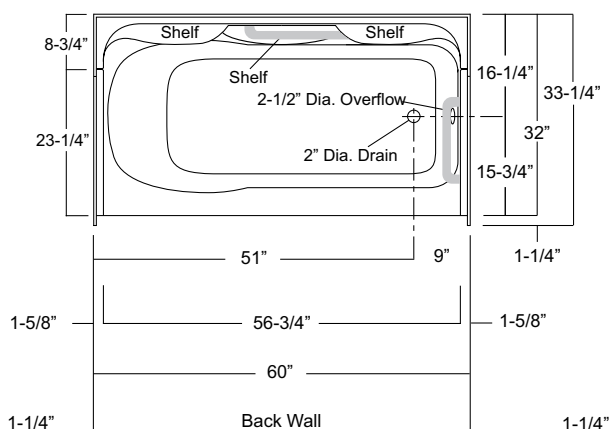

Enclosure Size:
56-3/4" w (max) x 59-3/4" h (max)

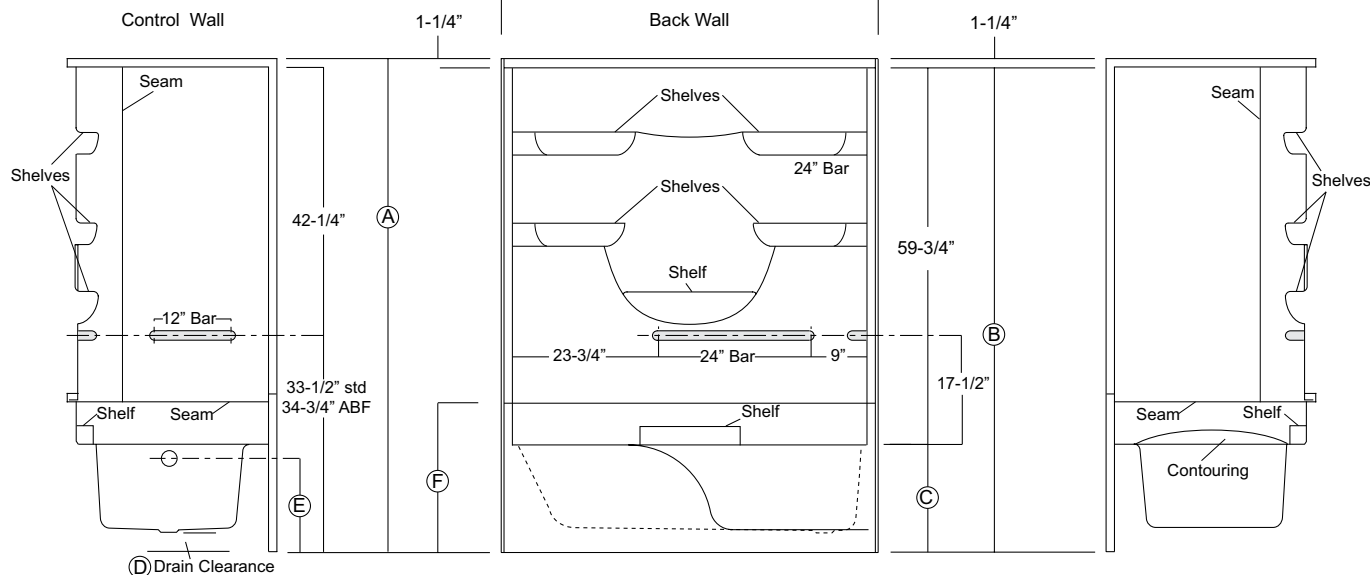

Dimensions shown are maximum. Due to the nature of the materials involved, actual unit dimensions can vary (tolerances: +0 / -1/8 inch).
Oasis reserves the right to modify or discontinue product and/or associated equipment without prior written or verbal notification or obligation.

Model ID	Package Code	Description (define configuration referencing drain end)
TS4P-6032 L (Std or ABF)	/ BP1-60 (left drain)	60" x 32", 4-piece, end drain, tub-shower, with 16" (Std) or 17.25" (ABF) apron, and ActivLife 1.50 dia. stainless steel 2-bar package (single horizontal back wall bar, single horizontal bar on control wall).
TS4P-6032 R (Std or ABF)	/ BP1-60 (right drain)	
Powder Coated Bar Packages (1.25-inch dia.)		
TS4P-6032 L (Std or ABF)	/ BP1-60 WHT (left drain)	60" x 32", 4-piece, end drain, tub-shower, with 16" (Std) or 17.25" (ABF) apron, and ActivLife 1.25" dia. white powder coated, 2-bar package (single horizontal back wall bar, single horizontal bar on control wall).
TS4P-6032 R (Std or ABF)	/ BP1-60 WHT (right drain)	
TS4P-6032 L (Std or ABF)	/ BP1-60 SNK (left drain)	60" x 32", 4-piece, end drain, tub-shower, with 16" (Std) or 17.25" (ABF) apron, and ActivLife 1.25" dia. nickel 2-bar package (single horizontal back wall bar, single horizontal bar on control wall).
TS4P-6032 R (Std or ABF)	/ BP1-60 SNK (right drain)	
ADD / SHWR ROD-TS		Factory installed 1" dia. stainless steel shower curtain rod.

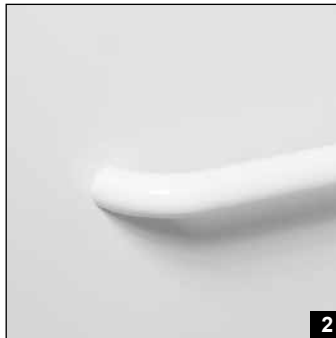
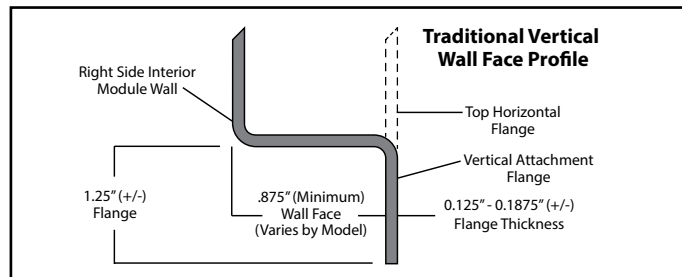

- Photo 1: Grab Bars: Factory-installed 1.50-inch diameter, concealed attachment, 18 gauge, #304 brushed stainless steel grab bars. Concealed attachment design provides tamper-resistance and minimizes debris collection areas at contact points, compared to common exposed flange bar designs, without compromising bar attachment integrity. (Reinforced areas include a structural core material encapsulated in FRP composite.)
- Photo 2: Grab Bars: Factory-installed 1.25-inch dia. powder coated (in finishes listed above), concealed attachment, 18 gauge, #304 stainless steel grab bars. Concealed attachment design provides tamper-resistance and minimizes debris collection areas at contact points, compared to common exposed flange bar designs, without compromising bar attachment integrity. (Reinforced areas include a structural core material encapsulated in FRP composite.)

Available Factory Installed Packages (model available without any component or reinforcement packages)

Component Packages:

- BP1-60 & BP2-60 package codes: 2-wall, 2-bar or 3-bar packages

Reinforced **ONLY** Packages:

- FH package code: reinforcement for vertical & horizontal bars, based on HUD/FHA-Fair Housing