

BARRIER-FREE SHOWER

Oasis



FLAT WALL ROLL-IN MODEL

SHMD-6232

Rough-In Dimensions

62" wide x 33-1/4" deep x 76-1/2" high

Finished Dimensions

62" wide x 32" deep x 75-1/4" high

Unit Features



- One - Piece Fiberglass Composite Construction
- Sanitary Grade Polyester Gelcoat Surface
- 3-3/8" Dia. Center Drain (see reverse side for location)
- 3/4" Threshold for Unobstructed Entry
- 1" Floor Flange To Secure Unit Along Threshold
- Elevated Back Wall Accessory Ledges
- Flat Wall Design To Accommodate Grab Bar & Seat Applications
- Textured Floor Pattern

Special Notes

- Factory Applied Reinforcement Packages Available
- Factory Applied Bar Configurations Available
- Factory Applied ADA & ANSI Compliant Bar & Seat Packages Available

Order No.: SHMD-6232

62" x 32" (60" x 30" interior dimension), one-piece gelcoated, flat-wall, fiberglass shower stall with minimal dam for barrier-free entry, dual back wall shelves, and center drain. Flat wall design allows for the installation of grab bars and seat.

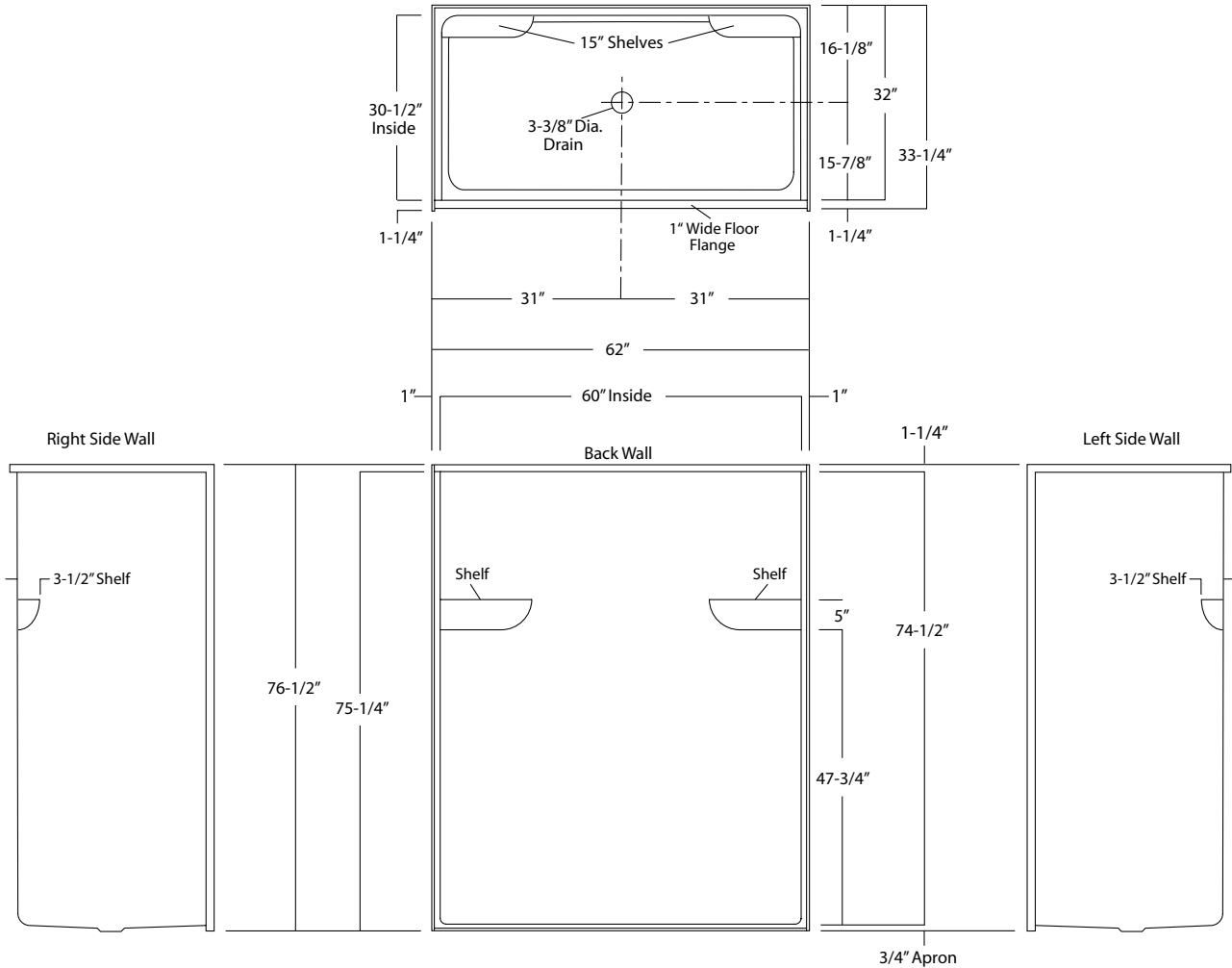

Package Order No.:

- | | | | |
|----------|----------------------------|--------------------------|---------------------------------------|
| Options: | SS Shower Rod (1*) | (order: ADD/SHWR ROD-TS) | Notes: (1*) Factory installed options |
| | SS Recessed Soap Dish (1*) | (order: SSD) | |
| | White, Ringless Curtain | (order: CRT-48-60) | |

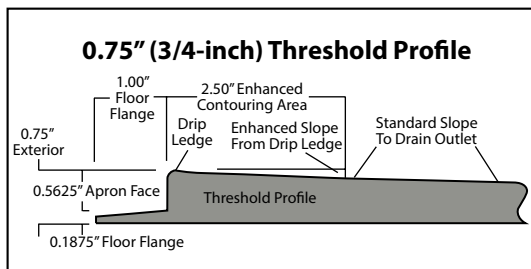

Photographic images may include optional components and appear different than actual product. Dimensions shown are maximum. Due to the nature of the materials involved, actual unit dimensions can vary (tolerances: +/-1/8 inch). Oasis reserves the right to modify or discontinue product and/or associated equipment without prior written or verbal notification or obligation.