

# Oasis 60-inch Shower Compartment With ActivLife (HUD/FHA Fair Housing Act Design Manual) Reinforcement Package



**Specification** – Oasis one-piece FRP gelcoat shower compartment SH-6040, offered in a standard 3-inch or 5-inch (ABF) dam configuration. ActivLife package includes a factory-applied reinforcement only package, in compliance with HUD/FHA Fair Housing Act Design Manual, shall include back wall and both side wall reinforcement, for horizontal bar application.

**Standards Certification:**

The shower compartment listed is manufactured in compliance with ANSI Z124 Standards, and certified through an ongoing, independent quality assurance and testing program.

60-inch / Private Access / Reinforced Only



**SH-6040 / FH**  
(Fair Housing reinforced)  
Model & Package Illustrated



|   | Std Unit | ABF Unit |
|---|----------|----------|
| A | 74-3/8"  | 76-3/8"  |
| B | 73-1/8"  | 75-1/8"  |
| C | 3"       | 5"       |
| D | 1"       | 3"       |
| E | -        | -        |
| F | -        | -        |

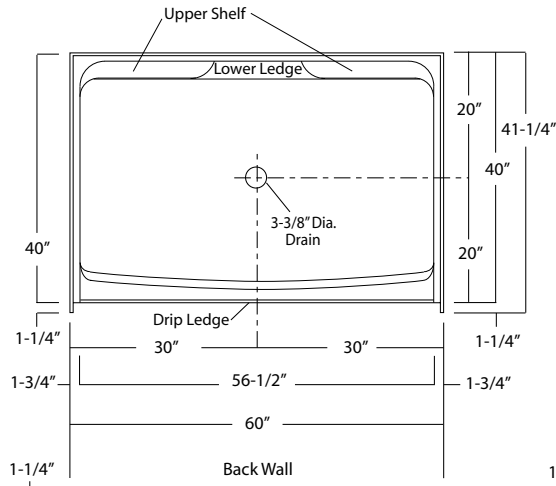

Enclosure Size:  
56-1/2" w (max) x 70-1/8" h (max)

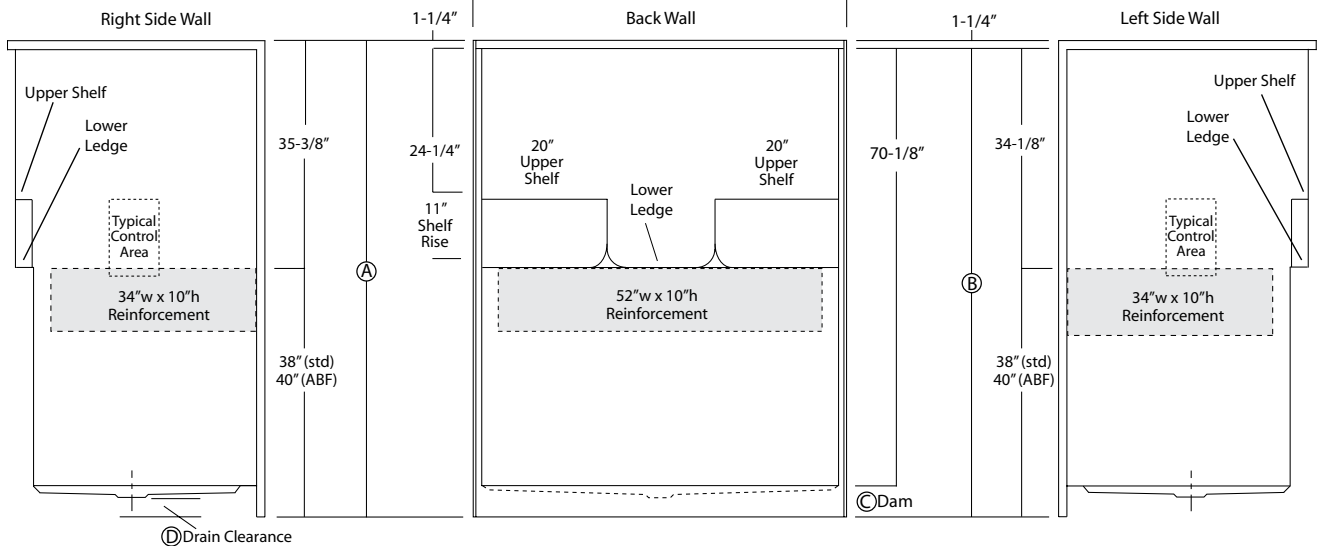

Dimensions shown are maximum. Due to the nature of the materials involved, actual unit dimensions can vary (tolerances: + / - 1/8 inch). Oasis reserves the right to modify or discontinue product and/or associated equipment without prior written or verbal notification or obligation.

| Model ID | Package Code | Description |
|----------|--------------|-------------|
|----------|--------------|-------------|

|                      |      |   |
|----------------------|------|---|
| SH-6040 (Std or ABF) | / FH | 60" x 40", center drain shower with 4" (std) or 6" (ABF) dam, and ActivLife 3-wall bar reinforcement only package for horizontal bar application. |
|----------------------|------|---|

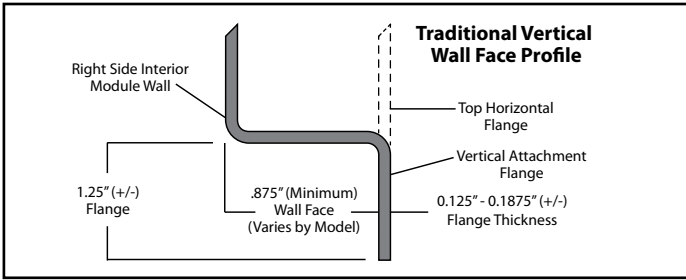

**Available Factory Installed Packages** (model available without any component or reinforcement packages)

**Component Packages:**

- 1. TLV package code: 2-wall, 3-bar package with phenolic folding RH or LH seat
- 2. TL package code: 2-wall, 2-bar package with phenolic folding RH or LH seat
- 3. BP2 package code: 2-wall, 3-bar package
- 4. BP1 package code: 2-wall, 2-bar package
- 5. BP3 package code: 3-wall, 3-bar package
- 6. BP5 package code: 1-wall, 1-bar package

**Reinforced ONLY Packages:**

- 7. FH package code: reinforcement for horizontal bars, based on HUD/FHA-Fair Housing
- 8. 3SM & 3SF package codes: expanded reinforcement packages, (with or without package components)